

Building future



FibroPlac



Tinkers & Thinkers

Smart Steel build the Future

www.tinthin.com



Open System

Design and conception of structures in Light Gauge Steel through a powerful calculation software and automatic CAD/CAM production

Powered by

Falper&Fibroplac

more information: tinthin@outlook.es



Light steel frame structure construction systems offer the fastest possible deployment, structural stability and the possibility of knowing within the project design phase the fire safety, and the building acoustic and thermal performance properties.

With a C100 section simple profile - 10/45/100/45/10 made out of GD350 hardness steel and from 0,8 mm to 2.0 mm thick, you can erect up to 4 floor buildings preserving an excellent cost rate.

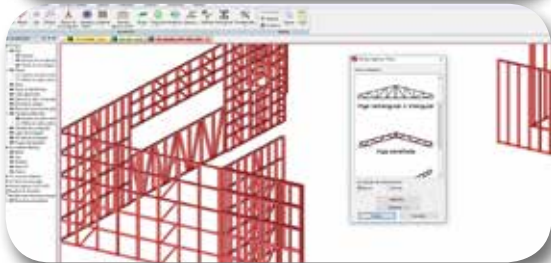
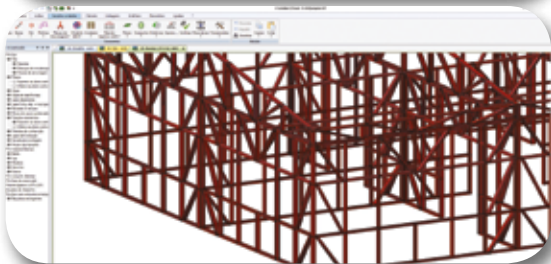
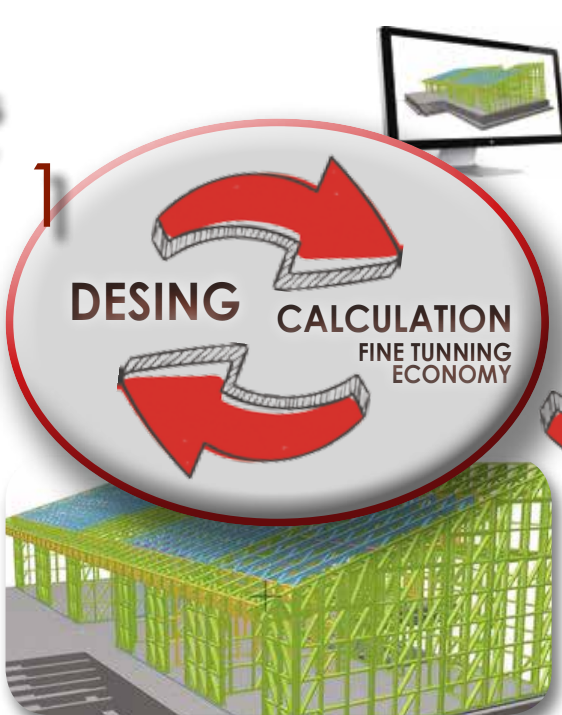
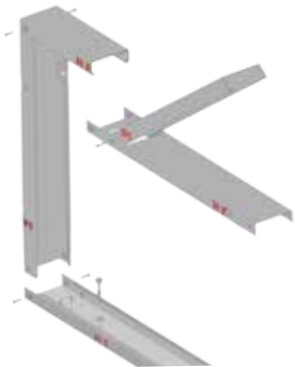

You can design and calculate integrating steel lightweight frames with all kinds of foundations and structural solutions